

WEST HIGGINS AND BEAVER CREEK TRAILS

MISSAUKEE, ROSCOMMON, CRAWFORD, AND KALKASKA COUNTIES

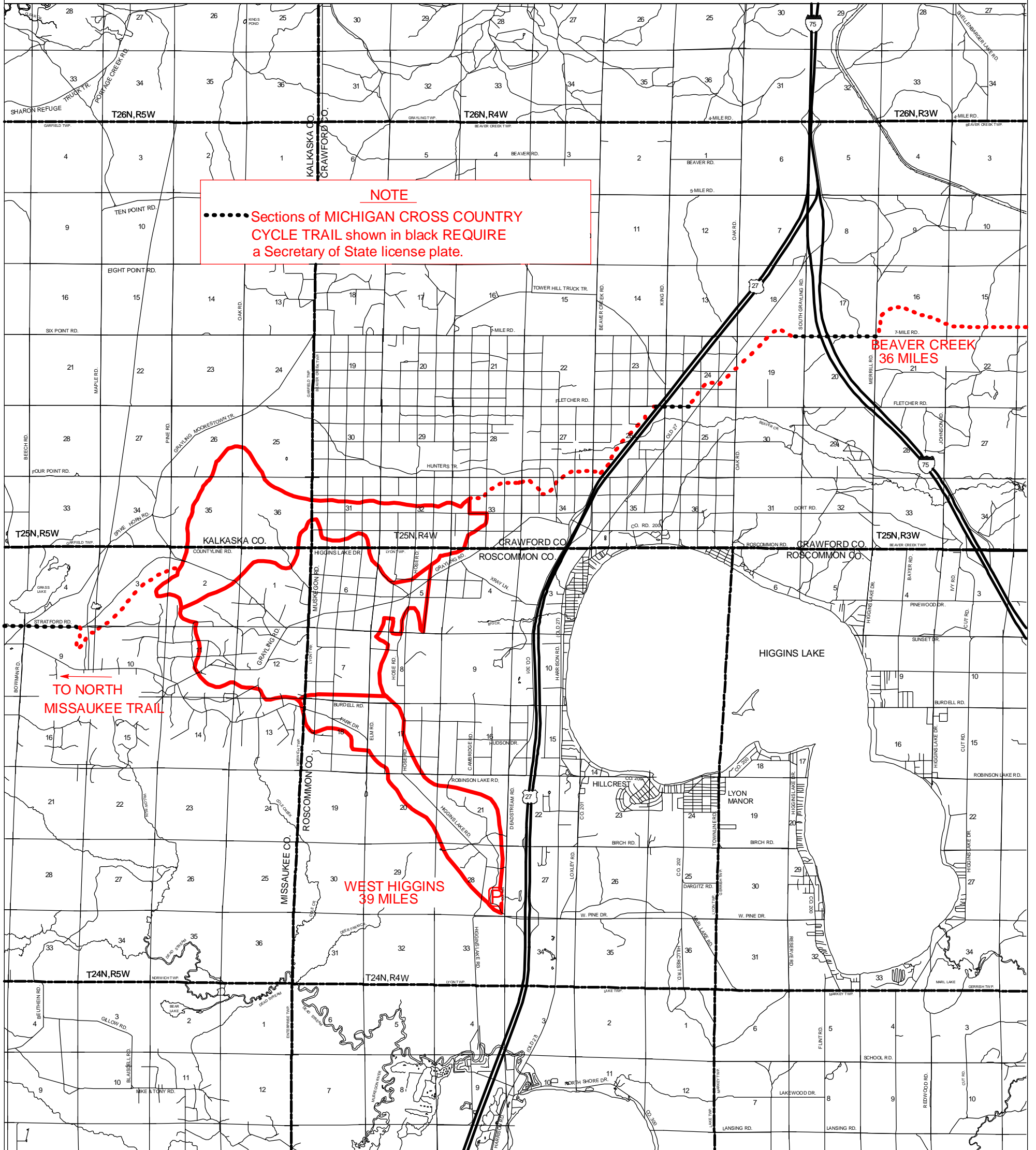

NOTE
 Sections of MICHIGAN CROSS COUNTRY CYCLE TRAIL shown in black REQUIRE a Secretary of State license plate.

TO NORTH
MISSAUKEE TRAIL

WEST HIGGINS
39 MILES

BEAVER CREEK
36 MILES

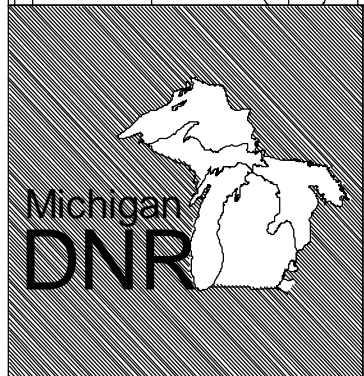

	ORV TRAIL-for ORV's less than 50" in width-off road motorcycles and/or ATV's. (DNR license required)
	ORV ROUTE-for ORV's of all sizes. (DNR license required unless licensed by Secretary of State)
	MICHIGAN CROSS COUNTRY CYCLE TRAIL (Sections require DNR license and Secretary of State license)

	PARKING
	CAMPGROUND
	GAS - FOOD

LEGEND

SCALE IN MILES: 0, .5, 1

LOCATION

SEPTEMBER 2003

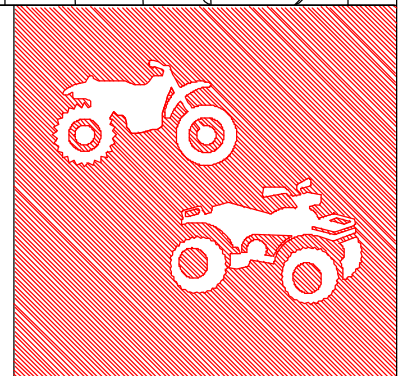

ADVISORY: Trails and Routes have two-way traffic.

DISCLAIMER: Trails shown on this map are an approximate representation of the trail system at the time of publication and may not reflect current ground conditions. **STAY ON SIGNED TRAILS ONLY!**