

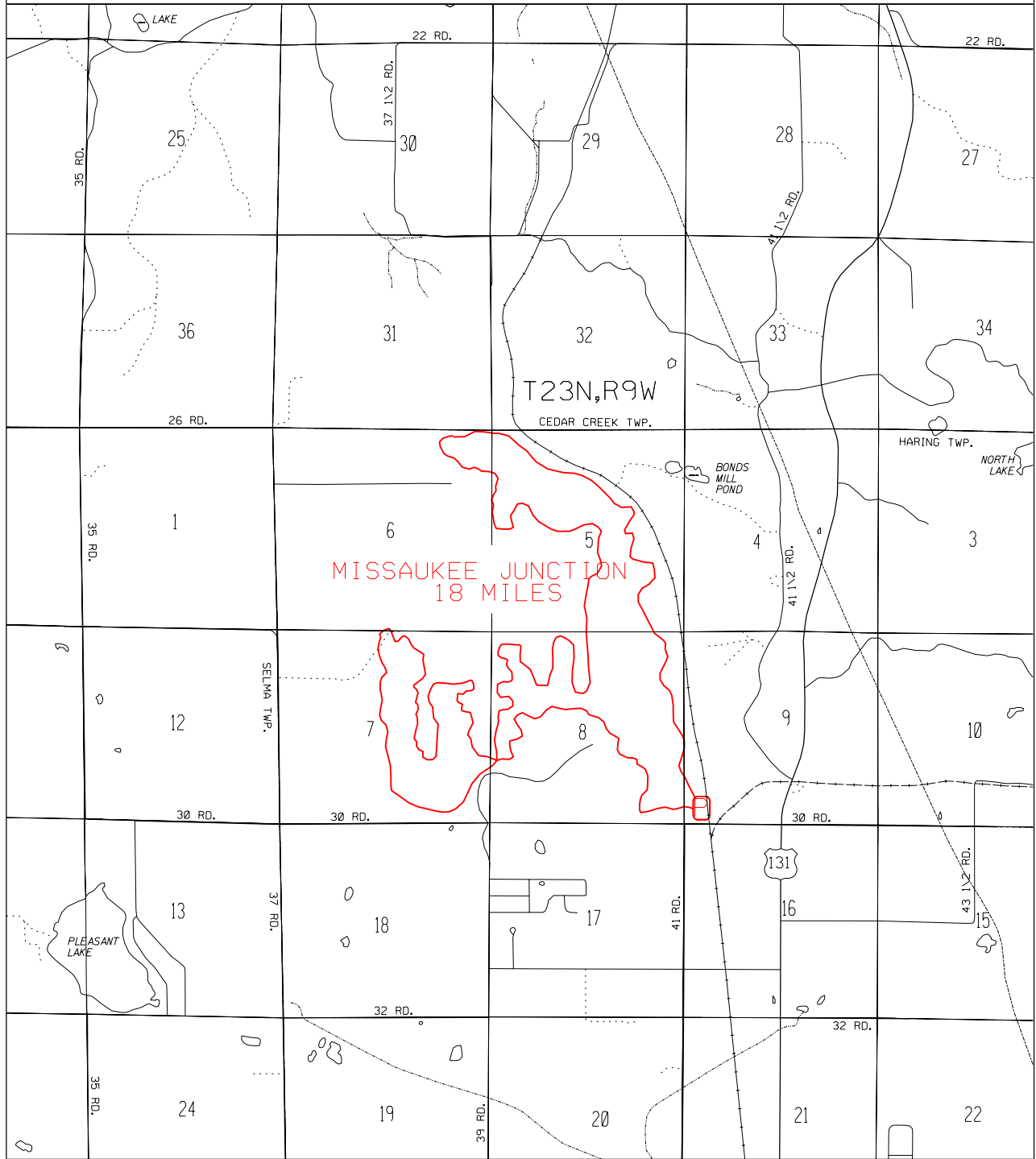

MISSAUKEE JUNCTION MOTORCYCLE TRAIL



WEXFORD COUNTIES

FOREST MANAGEMENT DIVISION



-  ORV TRAIL - for ORV's less than 50" in width-off road motorcycles. (DNR license required)
-  ORV ROUTE - for ORV's of all sizes. (DNR license required unless licensed by Secretary of State)

LEGEND

-  PARKING
-  CAMPGROUND
-  GAS - FOOD

0 .5
SCALE IN MILES

LOCATION



MAY 2005

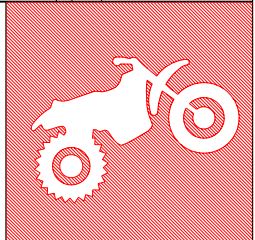

ADVISORY: Trails and Routes have two-way traffic.

DISCLAIMER: Trails shown on this map are an approximate representation of the trail system at the time of publication and may not reflect current ground conditions. STAY ON SIGNED TRAILS ONLY!

LONG LAKE MOTORCYCLE TRAIL

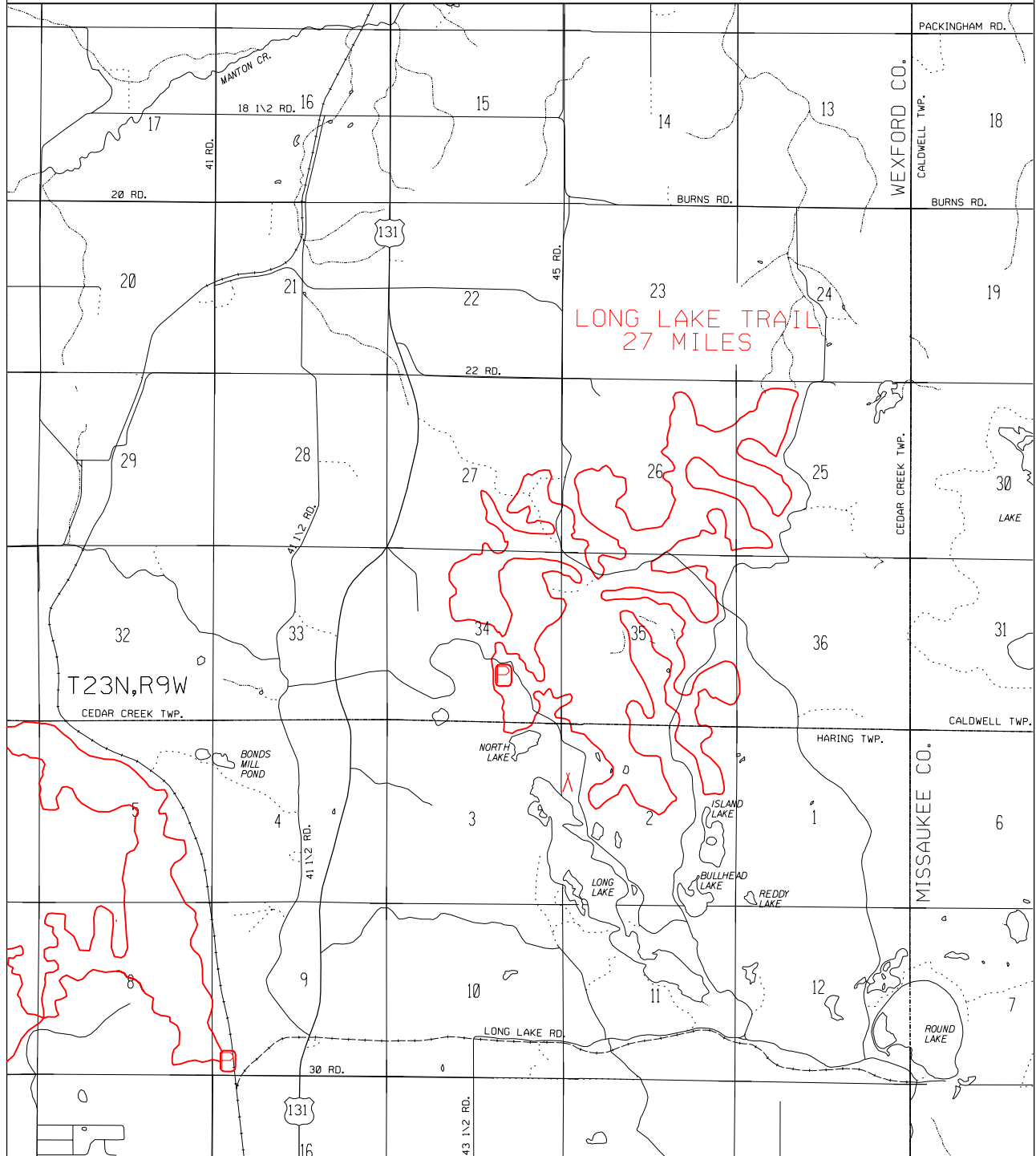

WEXFORD COUNTY
FOREST MANAGEMENT DIVISION



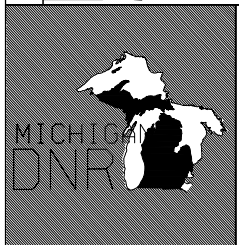

LONG LAKE TRAIL
27 MILES

T23N, R9W
CEDAR CREEK TWP.



-  ORV TRAIL - for ORV's less than 50" in width-off road motorcycles. (DNR license required)
-  ORV ROUTE - for ORV's of all sizes. (DNR license required unless licensed by Secretary of State)

LEGEND

-  PARKING
-  CAMPGROUND
-  GAS - FOOD

0 .5 1
SCALE IN MILES

LOCATION



MAY 2005

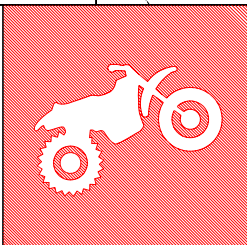

ADVISORY: Trails and Routes have two-way traffic.

DISCLAIMER: Trails shown on this map are an approximate representation of the trail system at the time of publication and may not reflect current ground conditions. **STAY ON SIGNED TRAILS ONLY!**