

NORTH MISSAUKEE TRAIL (west)

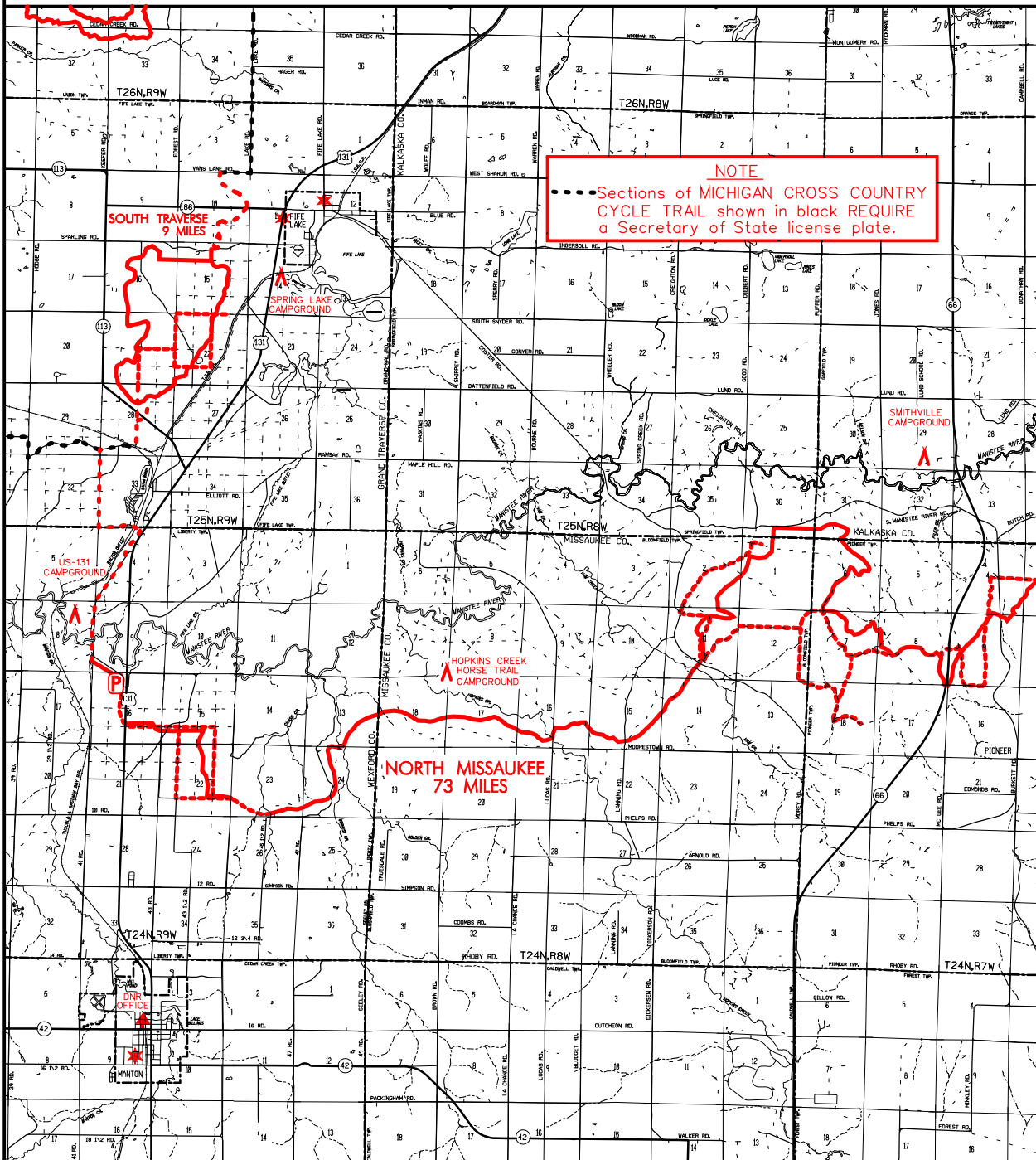

GRAND TRAVERSE, WEXFORD,
KALKASKA, AND MISSAUKEE COUNTIES

FOREST MANAGEMENT DIVISION





NOTE
Sections of MICHIGAN CROSS COUNTRY CYCLE TRAIL shown in black REQUIRE a Secretary of State license plate.



-  ORV TRAIL—for ORV's less than 50" in width-off road motorcycles and/or ATV's. (DNR license required)
-  ORV ROUTE—for ORV's of all sizes. (DNR license required unless licensed by Secretary of State)
-  MICHIGAN CROSS COUNTRY CYCLE TRAIL (Sections require DNR license and Secretary of State license)

LEGEND

-  PARKING
 -  CAMPGROUND
 -  GAS - FOOD
-  SCALE IN MILES
0 5 1

LOCATION

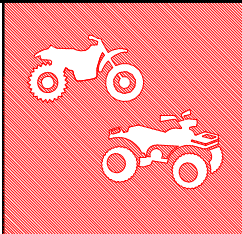

FEBRUARY 1999

ADVISORY: Trails and Routes have two-way traffic.

DISCLAIMER: Trails shown on this map are an approximate representation of the trail system at the time of publication and may not reflect current ground conditions. **STAY ON SIGNED TRAILS ONLY!**

NORTH MISSAUKEE TRAIL (east)

KALKASKA AND MISSAUKEE COUNTIES
FOREST MANAGEMENT DIVISION

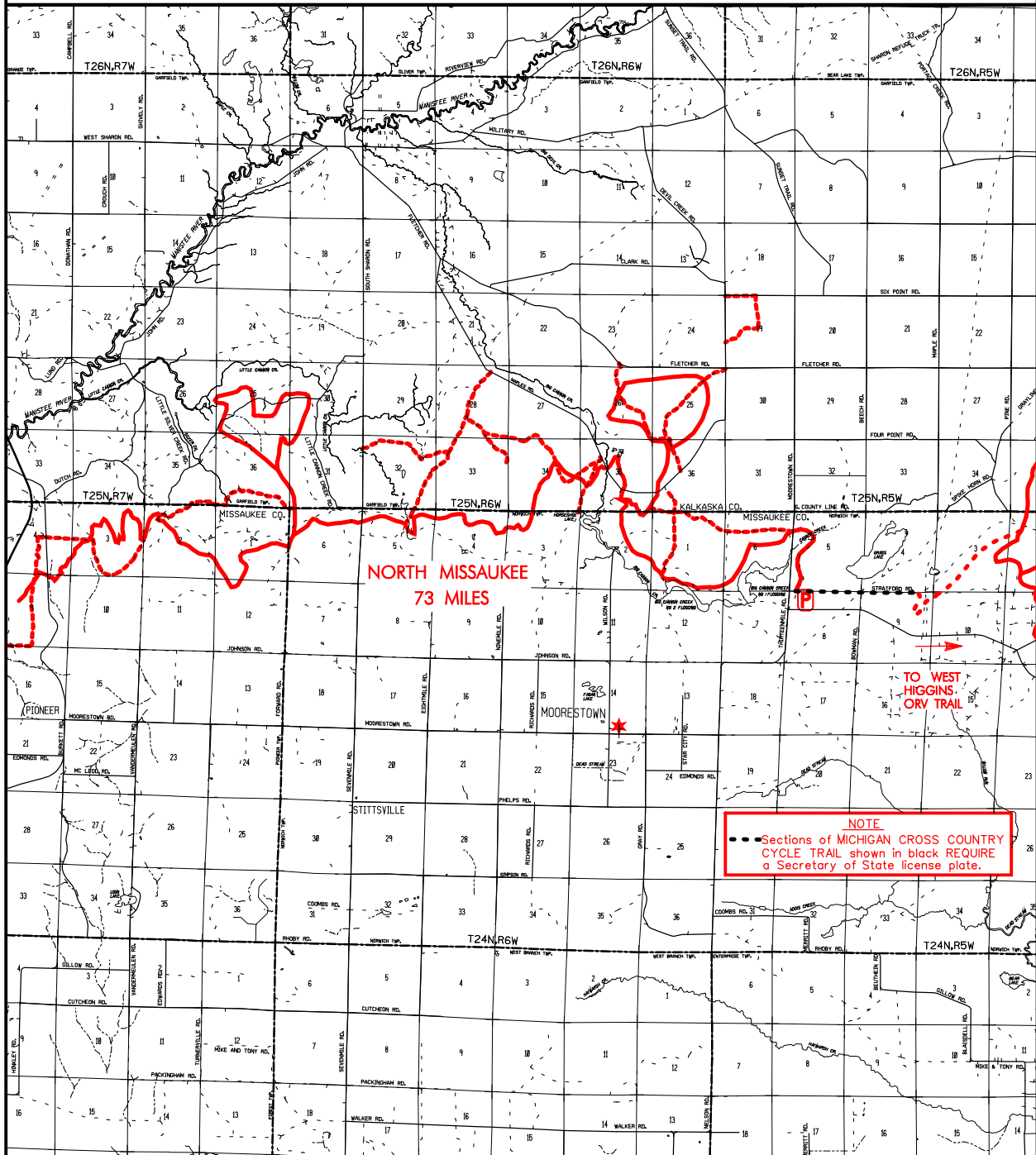

- ORV TRAIL - for ORV's less than 50" in width-off road motorcycles and/or ATV's. (DNR license required)
- ORV ROUTE - for ORV's of all sizes. (DNR license required unless licensed by Secretary of State)
- MICHIGAN CROSS COUNTRY CYCLE TRAIL (Sections require DNR license and Secretary of State license)

LEGEND

- PARKING
 - CAMPGROUND
 - GAS - FOOD
- 0 5 1
SCALE IN MILES

LOCATION



FEBRUARY 1999

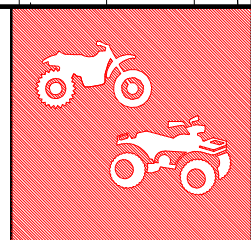

ADVISORY: Trails and Routes have two-way traffic.

DISCLAIMER: Trails shown on this map are an approximate representation of the trail system at the time of publication and may not reflect current ground conditions. STAY ON SIGNED TRAILS ONLY!